

MODELS:

- UMGN1000/32/1
- UAGN1000/32/1
- UMGN1000/32/3
- UAGN1000/32/3
- UAGN1000/32/1-FSLC



QMAX
PUMPING SYSTEMS
ABN 58 340 880 345
PO BOX 6006
72 HIGH STREET
QUEANBEYAN NSW 2620
P 02 6128 1000
F 02 6299 7613

ultraflow™
'the true value of quality'

SPECIFICATIONS		
Power	1.0kW / 1.33HP	
Frequency	50Hz	
Discharge	32mm / 1 1/4 inch female BSP	
Weight (Excl cable)	28Kg (25Kg - UMGN1000/32/3)	
Phase	1ø	3ø
Voltage	240	415
Full Load Amps	6.4	2.3
Maximum Liquid Temperature	0-40° C	
Maximum Submersion Depth	30m (100 feet)	
Motor type	Dry motor	
Motor Speed	2 Pole (2800 rpm)	
Motor Insulation	Class B	
Motor Protection	IP68	
Protector	Auto cut	
Motor Bearings	Ball Type	
Seal Method	Dual Mechanical seal Upper: Carbon/Ceramic Lower: Silicon/Silicon	
Impeller Type	Semi-open	
Motor Cover Construction	FC-200 Cast Iron	
Motor Casing Construction	FC-200 Cast Iron	
Motor Shaft Construction	403 Stainless Steel	
Pump Casing Construction	FC-200 Cast Iron	
Impeller Construction	FC-200 Cast Iron	
Grinder	Heat Treated 440 Stainless Steel	
Grinder Ring	Heat Treated 440 Stainless Steel	
Cable Material	H07RN-F	

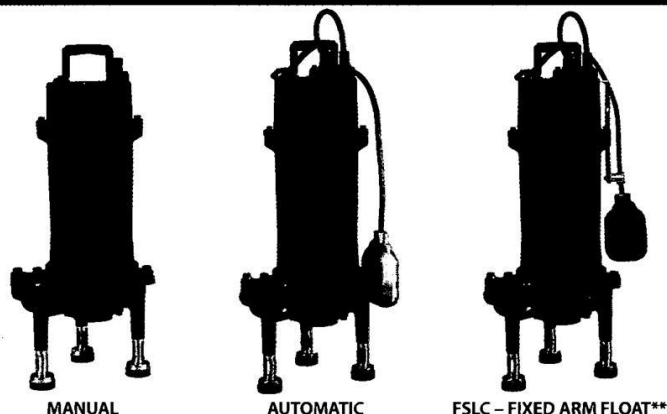

MODEL NUMBER STRUCTURE

UMGN1000/32/1

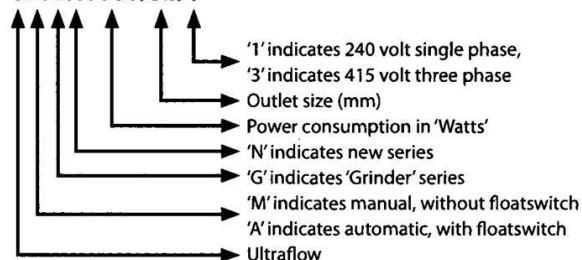

FSLC indicates pump is fitted with a fixed stainless steel arm bracket for floatswitch models which are used in applications to prevent the floatswitch from interfering with the sides of small pump wells

PERFORMANCE CURVES

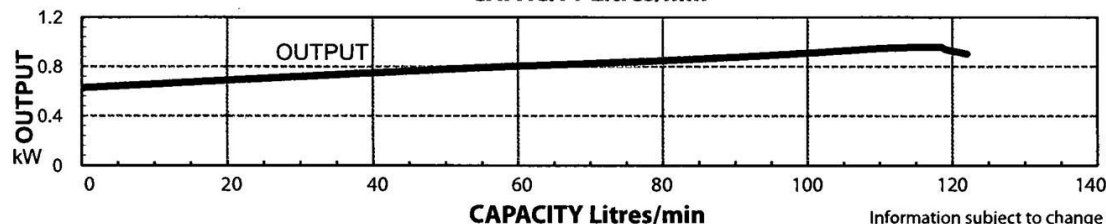
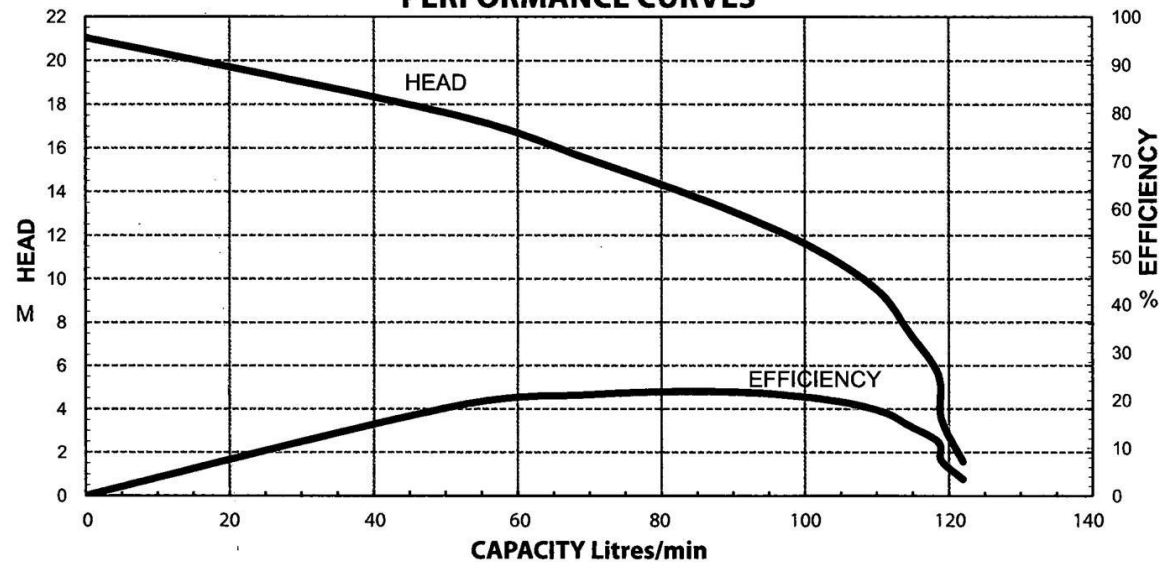

Information subject to change without notice.



MODELS:

UMGN1000/32/1
UAGN1000/32/1
UMGN1000/32/3
UAGN1000/32/3
UAGN1000/32/1-FSLC



QMAX
PUMPING SYSTEMS
ABN 58 340 880 345
PO BOX 6006
72 HIGH STREET
QUEANBEYAN NSW 2620
P 02 6128 1000
F 02 6299 7613

ultraflow™
'the true value of quality'

SECTIONAL DRAWING & MATERIALS LIST

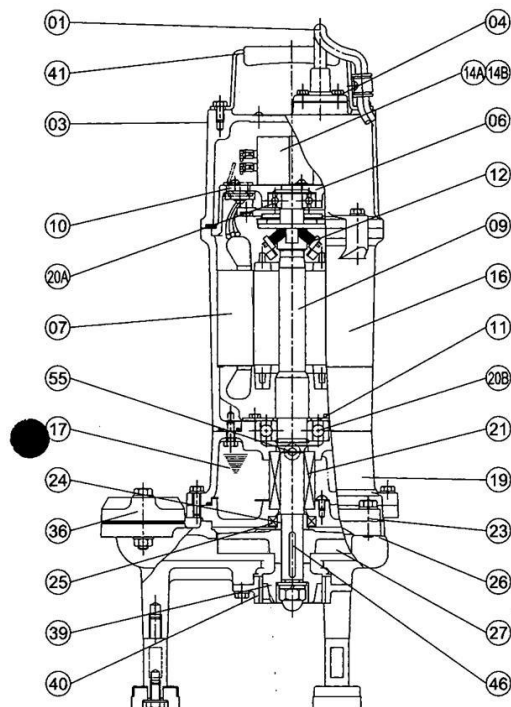

Part Number	Description	Material/Notes
01	Cable	HO7RN-F
03	Upper Motor Cap	Cast Iron FC-200
04	Cable Gland Cover	
06	Upper Bearing Housing	Cast Iron FC-200
07	Motor Stator	
09	Shaft With (With Rotor)	(Shaft) Stainless Steel 403
10	Auto Cut Out Overload	
12	Centrifugal Switch (240 volt models only)	(Transformer relay for UAGN1000/32/3)
14A	Capacitor (240 volt models)	
14B	Start Capacitor	(240 volt models only)
16	Motor Casing	Cast Iron FC-200
17	Lubricant	Turbine Oil
19	Lower Bearing Housing	Cast Iron FC-200
20A	Upper Bearing	
20B	Lower Bearing	
21	Mechanical Seal	Upper: Carbon/Ceramic Lower: Silicon/Silicon
23	Mechanical Seal Housing	Cast Iron FC-200
24	Oil Seal Bush	
25	Oil Seal	Nitrile
26	Pump Casing	Cast Iron FC-200
27	Impeller	Cast Iron FC-200
36	Outlet Flange	Cast Iron FC-200
39	Grinder	Heat Treated 440 Stainless Steel
40	Grinder ring	Heat Treated 440 Stainless Steel
41	Handle	304 Stainless Steel
46	Impeller Key	304 Stainless Steel
47	O'rings	
55	Oil Plug	304 Stainless Steel
FL	Floatswitch	

To order spare parts as above, it will be necessary to add the model number of the pump after the code listed above. For example, a power lead for a UAGN1000/32/1 would be written as '01-UAGN1000/32/1'.

DIMENSIONAL DRAWING

ELBOW (FLANGE) SET

GUIDE RAIL SYSTEM DIMENSIONS USING GR50 GUIDE RAIL KIT

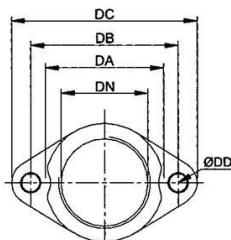
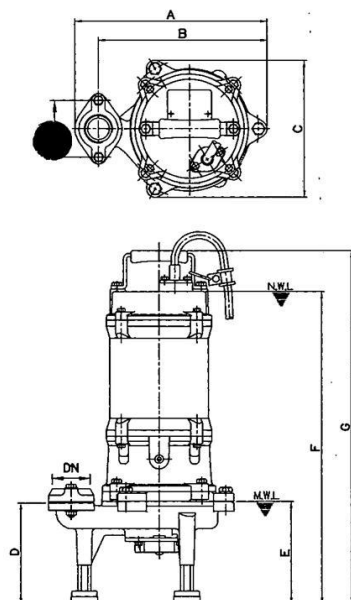

DIMENSIONS - mm				
DN	DA	DB	DC	DD
32	70	84	105	9.5

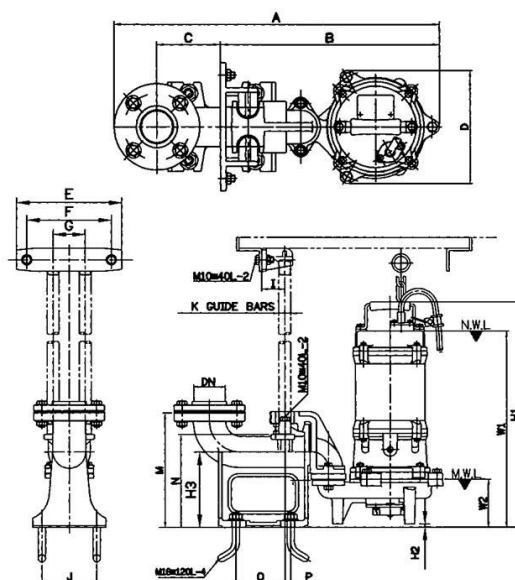

DIMENSIONS - mm								
UMGN1000/32/1, UAGN1000/32/1 & UAGN1000/32/3								
DN	DA	A	B	C	D	E	F	G
32	84	249	214	177	156	160	498	555

UMGN1000/32/3								
DN	DA	A	B	C	D	E	F	G
32	84	249	214	177	156	160	473	530

DIMENSIONS - mm																
UMGN1000/32/1, UAGN1000/32/1 & UAGN1000/32/3																
DN	A	B	C	D	E	F	G	I	J	K	M	N	O	P	W1	W2
50	552	359	115	177	230	185	70	50	120	25	203	108	13	445	90	502

UMGN1000/32/3																
DN	A	B	C	D	E	F	G	I	J	K	M	N	O	P	W1	W2
50	552	359	115	177	230	185	70	50	120	25	250	203	108	13	420	90

MODELS:

- UMGN1000/32/1
- UAGN1000/32/1
- UMGN1000/32/3
- UAGN1000/32/3
- UAGN1000/32/1-FSLC

QMAX
PUMPING SYSTEMS
ABN 58 340 880 345
PO BOX 6006
72 HIGH STREET
QUEANBEYAN NSW 2620
P 02 6128 1000
F 02 6299 7613

ultraflow™
'the true value of quality'

SECTIONAL DRAWING & MATERIALS LIST

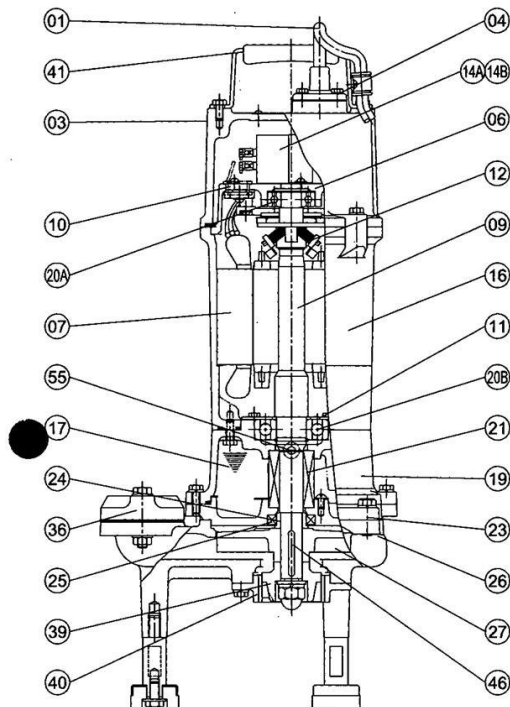

Part Number	Description	Material/Notes
01	Cable	HO7RN-F
03	Upper Motor Cap	Cast Iron FC-200
04	Cable Gland Cover	
06	Upper Bearing Housing	Cast Iron FC-200
07	Motor Stator	
09	Shaft With (With Rotor)	(Shaft) Stainless Steel 403
10	Auto Cut Out Overload	
12	Centrifugal Switch (240 volt models only)	(Transformer relay for UAGN1000/32/3)
14A	Capacitor (240 volt models)	
14B	Start Capacitor	(240 volt models only)
16	Motor Casing	Cast Iron FC-200
17	Lubricant	Turbine Oil
19	Lower Bearing Housing	Cast Iron FC-200
20A	Upper Bearing	
20B	Lower Bearing	
21	Mechanical Seal	Upper: Carbon/Ceramic Lower: Silicon/Silicon
23	Mechanical Seal Housing	Cast Iron FC-200
24	Oil Seal Bush	
25	Oil Seal	Nitrile
26	Pump Casing	Cast Iron FC-200
27	Impeller	Cast Iron FC-200
36	Outlet Flange	Cast Iron FC-200
39	Grinder	Heat Treated 440 Stainless Steel
40	Grinder ring	Heat Treated 440 Stainless Steel
41	Handle	304 Stainless Steel
46	Impeller Key	304 Stainless Steel
47	O'rings	
55	Oil Plug	304 Stainless Steel
FL	Floatswitch	

To order spare parts as above, it will be necessary to add the model number of the pump after the code listed above. For example, a power lead for a UAGN1000/32/1 would be written as '01-UAGN1000/32/1'.

DIMENSIONAL DRAWING

ELBOW (FLANGE) SET

GUIDE RAIL SYSTEM DIMENSIONS USING GR50 GUIDE RAIL KIT

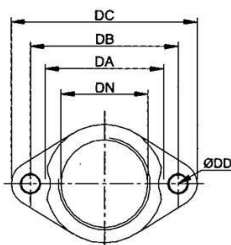
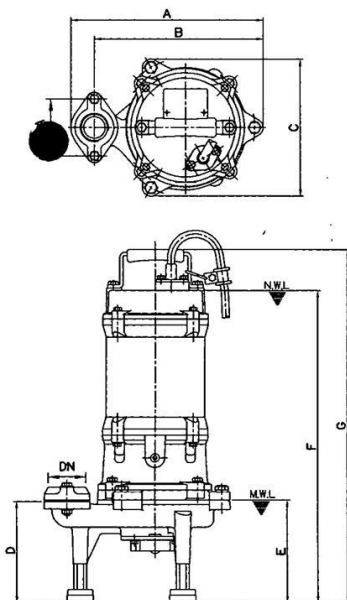

DIMENSIONS - mm				
DN	DA	DB	DC	DD
32	70	84	105	9.5

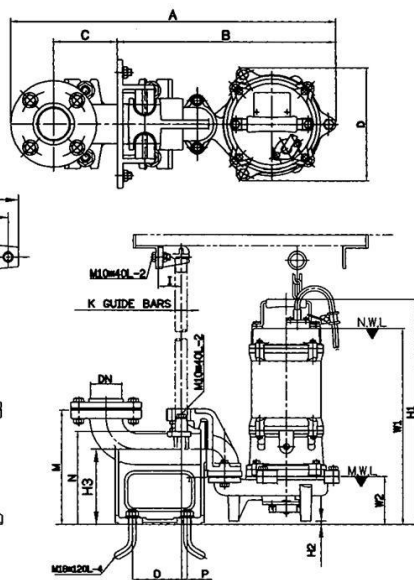
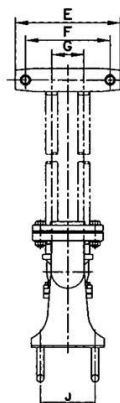

DIMENSIONS - mm								
UMGN1000/32/1, UAGN1000/32/1 & UAGN1000/32/3								
DN	DA	A	B	C	D	E	F	G
32	84	249	214	177	156	160	498	555
UMGN1000/32/3								
DN	DA	A	B	C	D	E	F	G
32	84	249	214	177	156	160	473	530

DIMENSIONS - mm																
UMGN1000/32/1, UAGN1000/32/1 & UAGN1000/32/3																
DN	A	B	C	D	E	F	G	I	J	K	M	N	O	P	W1	W2
50	552	359	115	177	230	185	70	50	120	25	250	203	108	13	445	90
UMGN1000/32/3																
DN	A	B	C	D	E	F	G	I	J	K	M	N	O	P	W1	W2
50	552	359	115	177	230	185	70	50	120	25	250	203	108	13	420	90



APPENDIX D

Building Plans and Elevations

Rapley Constructions Pty Ltd

FEBRUARY 2016

